



3M™ Speedglas™ Welding Helmet G5-02

To optimise the effective lifetime of your welding equipment and avoid the additional cost of replacement, regular maintenance is important. Replace all damaged parts immediately to ensure correct levels of protection.

Below is a helpful overview; always read and follow user instructions.

Before use

- ① **Helmet and head harness.** Inspect for cracks or any damaged parts. Replace if needed.
- ② **Cover lenses.** To provide the best possible vision, they should be clean and without scratches.
- ③ **Welding filter.** Ensure low battery indicator is not flashing and check that the sensors are clean and uncovered.

After use

- ① **Clean the helmet.** Wipe with a moist tissue or cloth, both inside and outside the helmet. DO NOT rinse, immerse in water or clean with solvents.
- ② **Sweatbands.** Remove for additional cleaning as needed and replace whenever they become unhygienic.
- ③ **Cover lenses.** Clean with a soft cloth and replace if any pits or scratches occur.
- ④ **Storage.** Store the helmet in a dry, clean area away from direct sunlight, high temperatures and solvents.

Spare parts and consumables

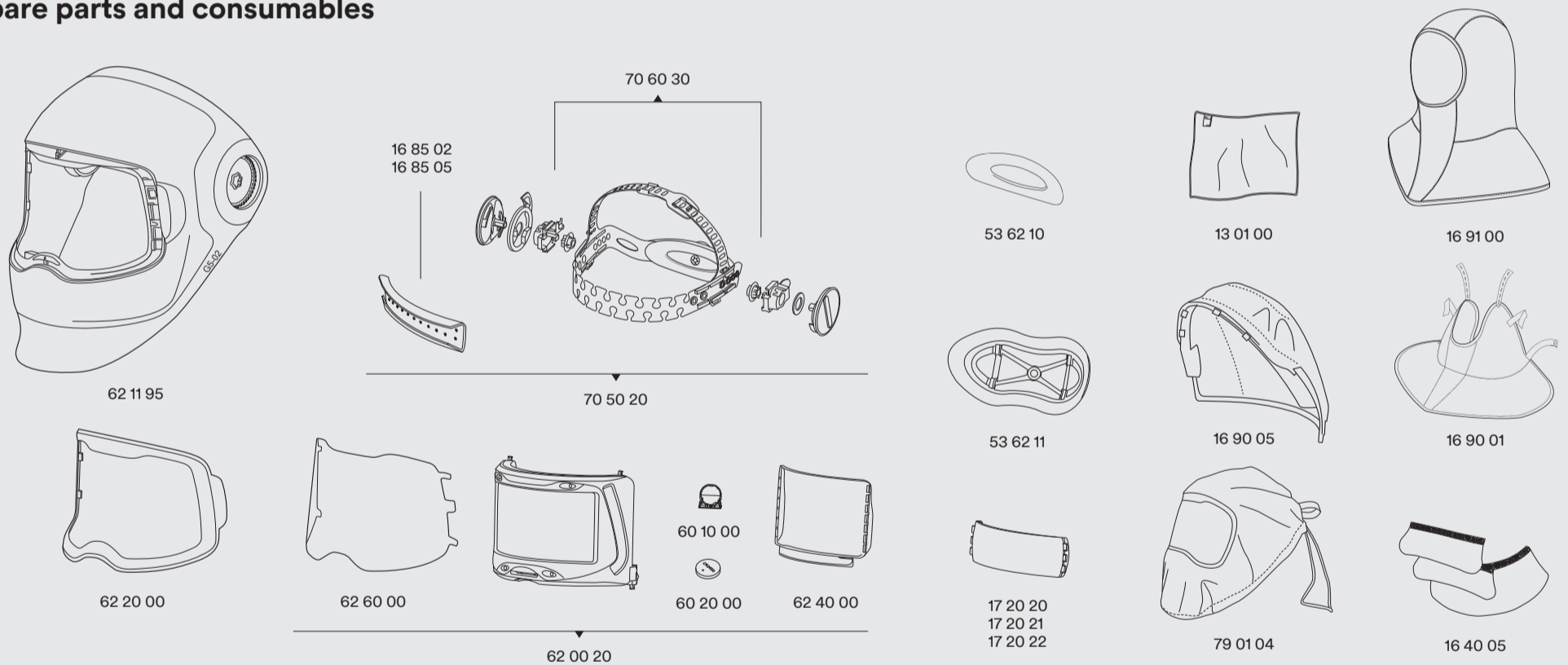

Part No	Description	Part No	Description	Part No	Description
13 01 00	3M Cleaning Wipe	53 62 11	Head Harness Back Cushion (Large)	70 50 20	Head Harness G5-02
16 40 05	Ear/Throat Protection Leather	60 10 00	Battery Holder	70 60 30	Head Harness Pivot Mechanisms
16 85 02	Sweatband Pk=2	60 20 00	Battery CR2450	79 01 04	Helmet Storage Bag G5-02
16 85 05	Sweatband Pk=5	62 00 20	Speedglas Curved Welding Lens G5-02		
16 90 01	Throat Protection Tecaweld	62 11 20	Helmet G5-02 with Welding Lens, Head Harness, Cleaning Wipe and Bag		
16 90 05	Head Protection	62 11 95	Helmet Exc Welding Lens, Head Harness & Front Cover		
16 91 00	Head Cape Tecaweld	62 20 00	Front Cover		
17 20 20	Magnifying Lens 1.5X	62 40 00	Lens Cover Inner Pk=2		
17 20 21	Magnifying Lens 2.0X	62 60 00	Lens Cover Outer Hard Coated Pk=5		
17 20 22	Magnifying Lens 2.5X				
53 62 10	Head Harness Back Cushion (Small)				