

Ejendals J alas Titan 1848K Welding Boots - Sizing Sheet



Directions to find your ideal J alas Boot size:

1. Lay a piece of paper square against a wall or another flat, perpendicular surface.
2. Whilst wearing the same socks that you wear for work, stand on the piece of paper with your heel touching the perpendicular surface and distribute your weight evenly.
3. With a pen, mark the furthest end point of your longest toe, on the piece of paper.
4. Be sure to measure the length of both feet. If one foot is larger than the other, use the measurement of the larger foot.
5. Using a tape measure or ruler, measure the distance in millimeters (mm) between the marking and the heel end of the paper.
6. Once you have determined the length of your foot add 5mm to ensure a comfortable fit.
7. Compare the required length, (foot length in mm + 5mm), to the J alas sizing chart below to select the correct size boots.



STEP 2



STEP 3

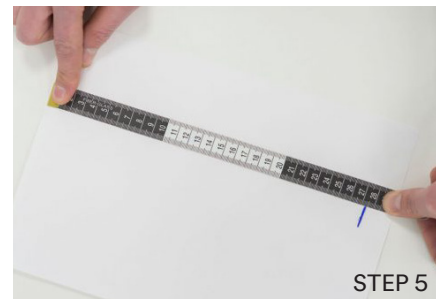

STEP 5

EXAMPLE:

- Using method above, measured foot to be 292mm in length
- Ensure 5mm space for comfort: $292\text{mm} + 5\text{ mm} = 297\text{mm}$
- Using chart below, the best J alas Boot Size is 45 (302mm)

J alas Boot Size	39	40	41	42	43	44	45	46	47	48
Length (mm)	262	269	276	282	289	296	302	309	316	323



WELDING TECHNOLOGY
SUPPLIERS OF WELDING AND ENGINEERING EQUIPMENT

Ph: 09 274 1246
info@weldingtechnology.co.nz
www.weldingtechnology.co.nz