



## MIG WELDING TORCHES

### XASP36 SPOOL GUN

#### 270A AIR COOLED SPOOL ON GUN MIG WELDING TORCH

Rating: 270A CO<sup>2</sup> 250A mixed gas EN60974-7 @ 60% duty cycle. 0.8 to 1.2mm wires

### Suregrip™ Series

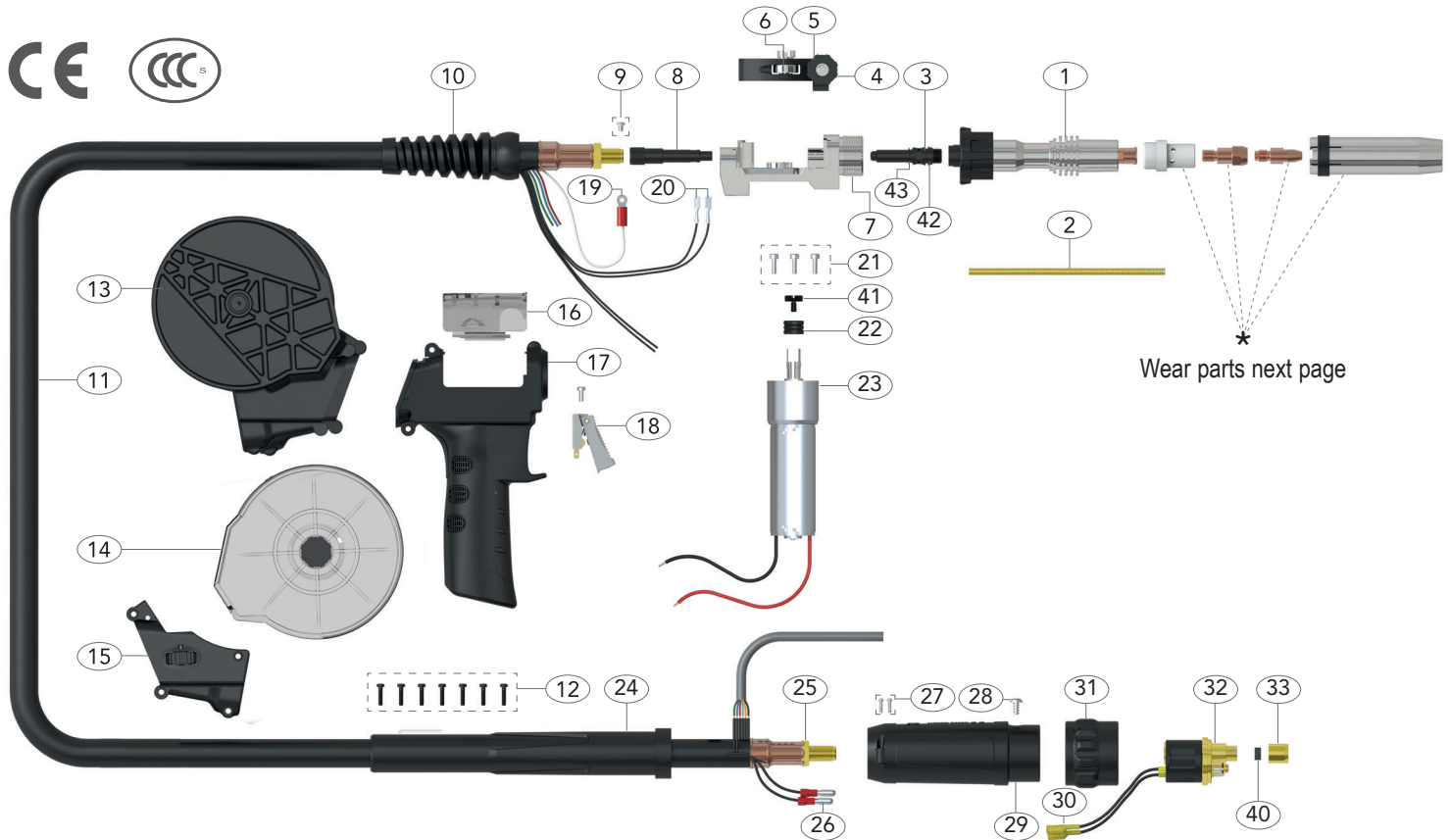

Wear parts next page

#### Torch Model

#### Part Number

#### Description

XASP36-24-P1-60ER

XA Suregrip Spool Gun 270A x 6m, 1K Pot, 24V Motor

#### Spare Parts

#### Part Number

#### Description

1	XAP3603A	Straight Neck Assembly
2	XAP3602A	Jump Liner
3	XAP36006	Jump Liner Nipple
4	XAP36402B	Tension Knob
5	XAP36402	Pressure Arm Assembly
6	XAP36402R	Pressure Roll
7	XAP36001	Motor Body
8	XAP36006	Wire Guide
9	XA2563	Screw
10	XA8015	Cable Support
11	XASP3609-60ER	Coax Cable Assembly, Euro Type
12	XAA3X20	Handle Screw Pack
13	XAP2515SP-B	Spool Box
14	XAP2515SP-C	Spool Cover
15	XAP2515SP-PT-1K	Wire Speed Control 1KΩ
	XAP2515SP-PT-5K	Wire Speed Control 5KΩ
	XAP2515SP-PT-10K	Wire Speed Control 10KΩ
16	XAP2514/C	Spool Gun Handle Cover
17	XAP2515/KJ	Spool Gun Handle
18	XAP2516	Push Pull Trigger
19	XA2597	Circular Cold Press Terminal
20	XA1521	Cable Terminal
21	XAPMS1	Motor Screw Pack

#### Spare Parts

#### Part Number

#### Description

22	XAP7020W-08U	Driver Roll For Aluminium Wire 0.8
	XAP7020W-09U	Driver Roll For Aluminium Wire 0.9
	XAP7020W-10U*	Driver Roll For Aluminium Wire 1.0
	XAP7020W-12U	Driver Roll For Aluminium Wire 1.2
	XAP7020W-16U	Driver Roll For Aluminium Wire 1.6
23	XAP7020-24	Motor 24V DC
	XAP7020-42	Motor 42V DC
24	XAA3541	Cable Support
25	XA1505	Lock Nut
26	XA1522	Cable Terminal Male
27	XASP1-1	Gun Plug Housing Screw
28	XA1541	Gun Plug Screw
29	XA2578H/L	Gun Plug Housing Assembly
30	XA1523	Gun Plug Terminal Female
31	XA1519/S	Housing Nut
32	XA1528	Hybrid Gun Plug Body with Pins
33	XA1525	Retaining Nut
40	XA1525W	Washer

\*Supplied standard with 1.0mm U Groove for Alloy Wire!