

PLASMA CUTTING TORCHES SC120 PLASMA TORCH & SPARES

Surecut SC120

Rating: 120A Air/N₂ Gas, @ 60% duty cycle.

For optional use on **RAZOR CUT80**

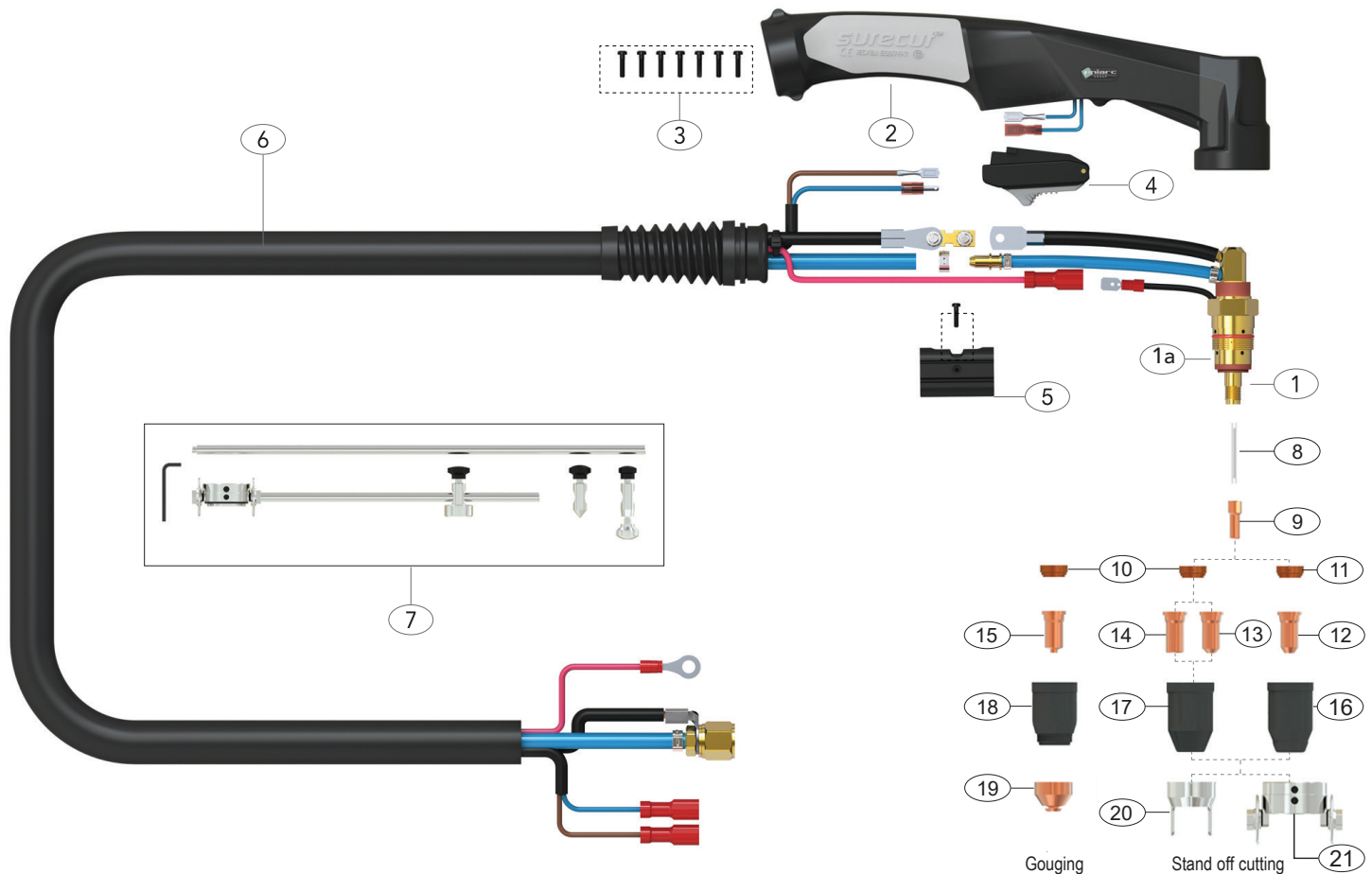

Technical Data

Max Current	120A	Gas Pressure	4.5-5.0 Bar (65-75psi)
Duty Cycle	60%	Gas Flow	200 l/min
Gas	Air/N		with Pilot Arc

Spare Parts

#	Part Number	Description
	SC120-60-CC1	Surecut 120 Plasma Torch x 6m
1	SC1201	SC120 70° Torch Head Kit
2	SC8014	Plasma Handle Kit
3	SCSP1	Screw Pack
4	SC2516	Plasma Safety Trigger
5	SC8015	Location Block
6	SC8019-60-CF4	Cable Assembly Complete x 6mt
7	SC1250	Circle Cutting Attachment Kit
8	SC1202	Cooling Tube
9	SC1204	Electrode
10	SC1207	Swirl Ring 4 Holes
11	SC1206	Swirl Ring 6 Holes Heavy Duty

Spare Parts

#	Part Number	Description
12	SC1220-10	Cutting Tip 1.0mm 40-50A
	SC1220-11	Cutting Tip 1.1mm 50-60A
	SC1220-12	Cutting Tip 1.2mm 60-70A
13	SC1221-14	Cutting Tip 1.4mm 80-90A
	SC1221-15	Cutting Tip 1.5mm 100-110A
	SC1221-16	Cutting Tip 1.6mm 110-120A
14	SC1222-09	Contact Cutting Tip 0.9mm 30-40A
15	SC1228-22	Gouging Tip 2.0mm 120A
16	SC1230	Retaining Cap, 30-70A
17	SC1231	Retaining Cap, 80-120A
18	SC1232	Shield Cap Body
19	SC8043	Shield Cap Gouging
20	SC1240	Double Pointed Spacer
21	SC1251	Cutting Buggy