

SURE CUT EXOTHERMIC SYSTEM



JRSC2024S-REG

The Oxylance Sure Cut System will cut virtually any metal, both ferrous and non-ferrous, and is faster than conventional oxy-acetylene cutting. Our system does not require preheating or cleaning the material before cutting. It is easy to use and is cost effective for most applications.

JRSC2024S Consists of:

- Holder
- 25' (7.62 m) x 10 mm Oxygen Hose
- 25' (7.62 m) x #4 Power Lead
- 25' (7.62 m) x #4 Ground Lead w/Striker Plate
- 1/4" (6.35 mm) and 3/8" (9.52 mm) Collet
- 12 ea 1/4" (6.35 mm) x 24" (609 mm) Sure Cut Rods
- 12 ea 3/8" (9.52 mm) x 24" (609 mm) Sure Cut Rods
- 26" (660 mm) Tool Box
- Requires 12 Volt Battery Power to Initiate
- Oxy Regulator 452X-175-IW

OXYGEN VOLUME & PRESSURE REQUIREMENTS

BURNING BAR DIAMETER	OPERATING PRESSURE		CUBIC FEET PER MINUTE	
.540" (1.3cm) O.D. (1/4" pipe (0.6cm))	Min. 90 psi	Max. 150 psi	20 cfm @ 90 psi	30 cfm @ 150 psi
.625" (1.5cm) O.D. (5/8" tube (1.5cm))	Min. 90 psi	Max. 150 psi	25 cfm @ 90 psi	40 cfm @ 150 psi
.675" (1.7cm) O.D. (3/8" tube (0.9cm))	Min. 90 psi	Max. 150 psi	30 cfm @ 90 psi	45 cfm @ 150 psi
.840" (2.1cm) O.D. (1/2" pipe (1.2cm))	Min. 90 psi	Max. 150 psi	60 cfm @ 90 psi	75 cfm @ 150 psi
.922" (2.3cm) O.D.	Min. 90 psi	Max. 150 psi	70 cfm @ 90 psi	85 cfm @ 150 psi
1.05" (2.6cm) O.D. (3/4" pipe (1.9cm))	Min. 90 psi	Max. 150 psi	80 cfm @ 90 psi	95 cfm @ 150 psi

SURE CUT CUTTING RODS



1/4" O.D.

Part No	Description	O2 Flow/Burn Time	Weight	Qty
25B24	1/4" x 24" Sure Cut Rod (bare)	3 to 5 cfm (0.08m ³ to 0.14m ³) / 1 Minute	7 lbs 3kg	25 pc box
25B36	1/4" x 36" Sure Cut Rod (bare)	3 to 5 cfm (0.08m ³ to 0.14m ³) / 1.5 Minutes	11 lbs 5kg	
25B48	1/4" x 48" Sure Cut Rod (bare)	3 to 5 cfm (0.08m ³ to 0.14m ³) / 2 Minutes	14 lbs 6kg	

3/8" O.D.

Part No	Description	O2 Flow/Burn Time	Weight	Qty
37B24	3/8" x 24" Sure Cut Rod (bare)	5 to 8 cfm (0.14m ³ to 0.22m ³) / 1 Minute	11 lbs 5kg	25 pc box
37B36	3/8" x 36" Sure Cut Rod (bare)	5 to 8 cfm (0.14m ³ to 0.22m ³) / 1.5 Minutes	17 lbs 7kg	
37B48	3/8" x 48" Sure Cut Rod (bare)	5 to 8 cfm (0.14m ³ to 0.22m ³) / 2 Minutes	22 lbs 10kg	

3/8" O.D. QUICK CONNECT

Part No	Description	O2 Flow/Burn Time	Weight	Qty
37B24QC	3/8" x 24" Quick Connect Sure Cut Rod (bare)	5 to 8 cfm (0.14m ³ to 0.22m ³) / 1 Minute	11 lbs 5kg	25 pc box
37B36QC	3/8" x 36" Quick Connect Sure Cut Rod (bare)	5 to 8 cfm (0.14m ³ to 0.22m ³) / 1.5 Minutes	17 lbs 7kg	
37B48QC	3/8" x 48" Quick Connect Sure Cut Rod (bare)	5 to 8 cfm (0.14m ³ to 0.22m ³) / 2 Minutes	22 lbs 10kg	

SURE CUT PARTS AND ACCESSORIES

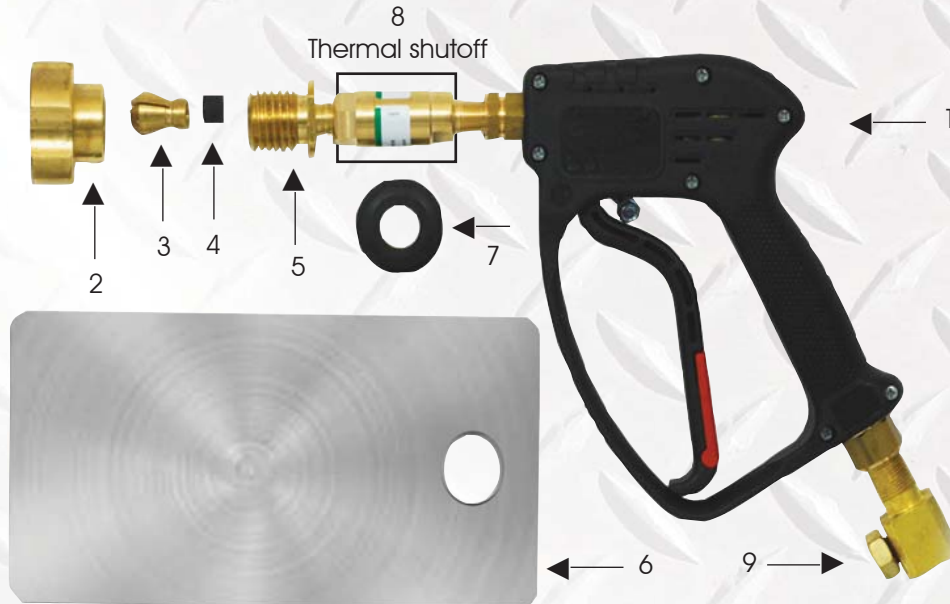

No	Part No	Description
1	JRSC200-RL31	Handle assembly
2	JRSC2000-2	Collet Nut
3	JRSC187-3	Collet for 5 mm (5 mm O.D.) Sure Cut rod's
3	JRSC250-3	Collet for 6 mm (6 mm O.D.) Sure Cut rod's
3	JRSC375-3	Collet for 9 mm (9 mm O.D.) Sure Cut rod's
4	JRSC2000-4	Collet Grommet (seals collet bolt to collet)
5	JRSC2000-5	Collet Bolt (6 mm NPT male X Collet seat)
6	JSRC2000-6	Curved Hand Shield
7	JSRC2000-7	Rubber insulator grommet for shield
8	OXY0250	Thermal Shutoff
9	JRSC2000-10	Power Block

No	Part No	Description
N/S	FTHW-142	9 mm NPT X CGE "B" fitting (For custom holder with no power block)
	HL41X25	8 m Oxygen hose (8 mm ID)
	JRSC2000-13	25 Welding Lead
	JRSC2000-14	Welding lead lug
	JRSC2000-15	Alligator Clamp
	JRSC2000-16	Copper Striker Plate
	JRSC6-32SCREW	Shield Screw
	JRSC6-32TEENUT	Shield Tee Nut
	JRSC200-G4000	Repair parts kit for Oxygen Valve
	JRSCBE43HP	Collet Bolt Extension

N/S Not shown in diagram

Carry Case / Tool Box

Part No	Carry Case / Tool Box
JRTB1	Black Plastic Carrying Case (small)
JRTB2	66 cm Dura Bull Tool Box
JRTB3	Large Pelican Case #1650 with locking handle and wheels
JRCENJ900	Igniter Pack